

Kuala Terengganu
 Terengganu
 Kemaman Harbor

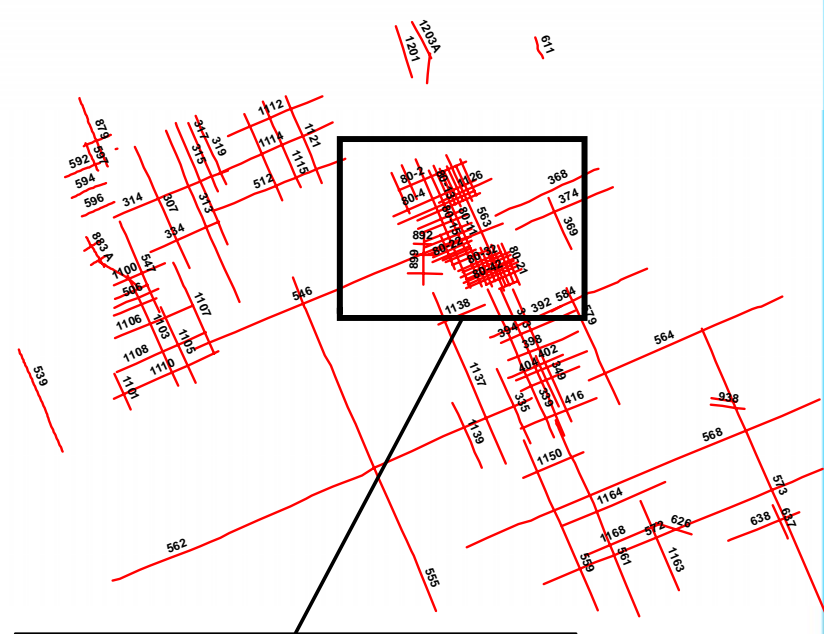

SEITEL DATA

Houston (713) 881-8900 Denver (303) 292-1990
 New Orleans (504) 582-2290 Calgary (403) 515-2800

Natuna 2D

— Phase 2 Natuna

0 10 20 40 60 80
 Kilometers

SOME OF THE DATA USED TO PRODUCE THIS MAP IS COPYRIGHTED BY TOBIN INTERNATIONAL LLC AND ALL RIGHTS ARE RESERVED BY TOBIN INTERNATIONAL. SEITEL INCORPORATED IS A LICENSEE FOR THE USE OF THIS DATA AND NO COPY, REPRODUCTION OR DISTRIBUTION HEREOF MAY BE MADE WITHOUT THE PRIOR WRITTEN CONSENT OF TOBIN INTERNATIONAL.

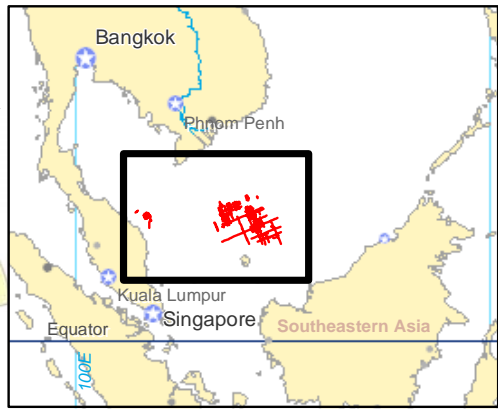

Natuna Phase 2

Phase II

1st Field Configuration:

- Cmp spacing 35 meter
- Shot spacing 140 meter
- Maximum offset 1963 meter
- Channels 24
- Record length 5 second
- Vintage 1970-1973

2nd Field Configuration:

- Cmp spacing 25 meter
- Shot spacing 50 meter
- Maximum Offset 2638 meter
- Channels 48
- Record Length 6 second
- Vintage 1974-1975

Products:

- Basic
- Migration-filter/scale
- Migration velocities

Line	First Shot	Last Shot	Miles	Kilometers	Line	First Shot	Last Shot	Miles	Kilometers	Line	First Shot	Last Shot	Miles	Kilometers	Line	First Shot	Last Shot	Miles	Kilometers	
1203A	1	381	11.41	18.3701	612	-5	128	11.47	18.4667	80-26	100	665	8.92	14.3612	936	1	162	6.94	11.1734	
1203B	1	269	8.33	13.4113	626	-5	115	10.24	16.4064	80-27	100	896	12.25	19.7225	938	25	445	9.48	15.2628	
307	1	420	36.84	59.3124	637	-3	114	10.11	16.2771	80-28	100	760	10.46	16.8406	BSA-1	4	430	6.65	10.7065	
313	-10	587	51.76	83.3336	638	-5	236	21.03	33.8583	80-29	100	733	9.9	15.939	BSA-10	1	410	6.46	10.4006	
314	1	386	34.08	54.8688	1100	1	510	15.3	24.633	80-3	100	793	10.68	17.1948	BSA-12	1	410	6.54	10.5294	
315	-12	403	36.52	58.7972	1101	1	830	10.88	17.5168	80-30	100	932	12.8	20.608	BSA-2	1	410	6.58	10.5938	
317	1	234	20.66	33.2626	1102	-32	358	9.72	15.6492	80-31	100	733	10.07	16.2127	BSA-3	1	430	6.49	10.4489	
319	-12	220	20.71	33.3431	1103	-32	1053	33.74	54.3214	80-32	100	1005	14.05	22.6205	BSA-4	1	410	6.44	10.3684	
334	-12	225	20.72	33.3592	1104	1	736	12.67	20.3987	80-33	100	764	10.38	16.7118	BSA-5	1	430	6.57	10.5777	
335	-12	244	22.62	36.4182	1105	1	735	22.97	36.9817	80-34	100	1070	15.04	24.2144	BSA-6	1	410	6.56	10.5616	
339	1	500	44.9	72.289	1106	-32	969	23.26	37.4486	80-36	100	1056	15.15	24.3915	BSA-7	1	430	6.58	10.5938	
343	1	503	44	70.84	1107	-34	857	27.61	44.4521	80-38	100	1065	14.99	24.1339	BSA-8	1	410	6.47	10.4167	
345	-12	161	15.27	24.6847	1108	-50	1160	26.86	43.2446	80-4	100	1595	24.73	39.8153	BSA-9	1	425	6.6	10.626	
349	37	494	39.93	64.2873	1110	1	1230	31.73	51.0853	80-40	100	1051	14.98	24.1178	WBSA-1	1	1215	18.84	30.3324	
368	-12	340	31.28	50.3608	1112	1	939	28.18	45.3698	80-42	100	1076	15.2	24.472	WBSA-2	1	572	8.87	14.2807	
369	-12	165	15.48	24.9228	1113	1	834	26.13	42.0693	80-44	100	778	10.64	17.1304	WBSA-4	1	578	8.95	14.4095	
374	-20	308	29.08	46.8188	1114	-32	1084	34.59	55.6899	80-46	100	464	5.58	8.9838	WBSA-6	1	572	9.02	14.5222	
392	-12	227	21.37	34.4057	1115	-40	796	25.97	41.8117	80-5	100	805	10.74	17.2914	WBSA-8	1	724	11.4	18.354	
394	1	248	22.33	35.9513	1121	1	843	26	41.86	80-6	100	1584	22.89	36.8529						
398	1	236	20.8	33.488	1126	1	509	15.91	25.6151	80-7	100	800	10.78	17.3558						
402	-12	172	16.45	26.4845	1137	-90	1554	51.45	82.8345	80-8	100	1329	18.88	30.3968						
404	1	244	21.13	34.0193	1138	-6	437	13.82	22.2502	80-9	100	805	10.76	17.3236						
406	1	206	17.53	28.2233	1139	1	633	19.76	31.8136	876	-2	186	8.19	13.1859						
416	-12	277	22.47	36.1767	1150	1	590	18.04	29.0444	878	1	193	0.68	1.0948						
506	48	264	13.15	21.1715	1163	-32	817	27.04	43.5344	879	1	473	20.49	32.9889						
512	1	518	39.44	63.4984	1164	1	1004	31.11	50.0871	882	1	116	5	8.05						
539	1	310	30.88	49.7168	1168	1	765	23.07	37.1427	883 A	1	225	9.58	15.4238						
546	1	1053	91.64	147.5404	1201	1	506	14.88	23.9568	883 B	1	291	12.83	20.6663						
547	10	306	27.31	43.9691	80-1	175	798	10.85	17.4685	884	1	118	5.17	8.3237						
555	-20	1166	100.82	162.3202	80-10	100	977	13.54	21.7994	882	1	107	4.62	7.4382						
559	1	600	51.44	82.8184	80-11	100	2432	36.04	58.0244	884	1	138	6.02	9.6822						
561	-22	672	59.16	95.2476	80-12	100	972	13.51	21.7511	888	-1	217	9.54	15.3594						
562	1	1695	126.3	203.343	80-13	100	2389	35.41	57.0101	889	0	330	14.24	22.9264						
563	-4	482	39.75	63.9975	80-14	100	927	13.59	21.8799	900	1	182	7.93	12.7673						
564	1	661	58.12	93.5732	80-15	100	2596	38.62	62.1782	901	10	239	10.18	16.3898						
568	1	1217	105.57	169.9677	80-16	100	988	13.7	22.057	902	3	180	7.78	12.5258						
572	1	954	83.27	134.0647	80-17	100	757	10.19	16.4059	903	0	172	7.23	11.6403						
573	1250	2234	85.66	137.9126	80-18	100	929	12.9	20.769	904	1	183	8.02	12.9122						
579	1	405	35.29	56.8169	80-19	100	900	12.39	19.9479	905	-31	156	4.79	7.7119						
584	-10	313	28.93	46.5773	80-2	100	1381	20.13	32.4093	906	1	143	6.07	9.7727						
592	1	120	10.33	16.6313	80-20	100	856	11.55	18.5955	907	1	200	8.36	13.4596						
594	-5	113	10.43	16.7923	80-21	100	850	12.45	20.0445	908	1	145	6.16	9.9176						
596	1	109	9.74	15.6814	80-22	100	841	11.15	17.9515	910	1	145	6.22	10.0142						
597	1	96	8.41	13.5401	80-23	100	819	11.4	18.354	915	64	599	25.84	41.6024						
611	1	71	6.15	9.9015	80-24	100	641	8.41	13.5401											
597	1	96	8.41	13.5401	80-25	100	700	12.14	19.5454											
611	1	71	6.15	9.9015																



For a detailed description and assistance in licensing these products contact

Houston (832) 295-8300
 Denver (303) 292-1990
 New Orleans (504) 582-2290

sales@seitel-inc.com

